



# McLean, Illinois Community Profile Overnight Itinerary



Located on Route 66 at the intersection of Interstate 55 and Route 136, McLean is a quiet, friendly community with a population of 806 that is proud to be the home of the historic Dixie truck stop and diner. The Village of McLean is currently working on plans to develop the area to the south and west of the McLean Depot, making it a fun and inviting space for Route 66 travelers and residents alike.

## McLean Depot Concepts

Conceptual Plan

McLean, Illinois  
October 11, 2016

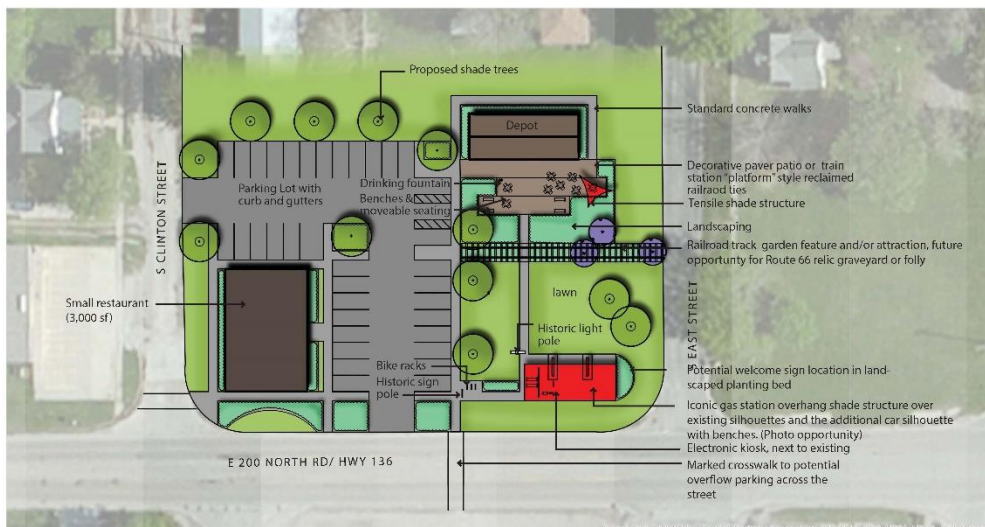

**Parking Lot:**  
37 Stalls total  
7 ADA Stalls

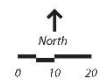

11x17 Scale: 1:20

## McLean Depot Concepts

Vision Graphics

McLean, Illinois  
October 11, 2016



## ATTRACTIONS



### [Dixie Truck Stop](#)

In 1928, J.P. Walters and John Geske rented part of a mechanic's garage here to sell sandwiches to Route 66 travelers and truckers. By the 1930's, the operation had grown to a full-fledged restaurant, cabins, and a cattle pen. The Dixie was owned and operated by the Geske family from 1928-2003 and was only closed one day after a fire in 1965. The truck stop has changed hands, but still serves travelers along Route 66 and I-55, 24 hours a day, 365 days a year. 222 North Front Street

(501 Main Street

(309) 874-2323

[Dixie Truck Stop Facebook Page](#)



### [McLean Depot Train Shop/A Home on the Road Interpretive Statue](#)

Located in the restored old GM&O, Alton Route depot, McLean Depot Train Shop is a full line and growing hobby shop specializing in model railroading, offering kits, ready to run, starter sets, an extensive selection of new and out-of-print books and much more. Stop in and see the model railroad displays.



Planning is underway for an expanded Route 66 attraction in the area south and west of the McLean Depot, anchored around the Illinois Route 66 Scenic Byway including a “Home on the Road” Interpretive Statue that pays tribute to the Dixie Truck stop located across the street.

200 East Dixie Road

(309) 244-5900

[McLean Depot Official Website](#)



### [Shorty's Barber Shop Route 66 Walldogs Mural](#)



Visit the exciting new downtown mural, officially created by the Walldogs – an international group of highly skilled sign painters and mural artists. This mural features a vintage Route 66 theme and honors local legend, Shorty Ruble, and his long-standing barbershop.

Downtown McLean

(309) 874-2102

[McLean – Shorty’s Mural Official Website](#)



#### [Arcadia: America’s Playable Arcade Museum](#)

Check out America’s Playable Arcade Museum where, as the name says, you can play 70+ fully functioning arcade game machines from the 70s onward. This experience is truly like walking into a fully stocked arcade circa 1983. Arcadia has something for everyone to play.

107 South Hamilton Street

(309) 287-1725

[Arcadia Playable Arcade Museum Official Website](#)



#### [Pinball Paradise: America’s Playable Pinball Museum](#)

Pinball was born and raised in Illinois, and there are few places left in Illinois where the public can still play pinball games. Where can you play a classic Magic Town, Top Card, Baseball, Whirlwind, Bride of Pinbot, Super Mario Brothers, or Theatre of Magic pinball? Pinball Paradise! Located in the historic McLean State Bank building, they have about 40 playable pinball machines (to start, more later) from the 1960s through the 2000s.

102 East Morgan Street

(309) 287-1725

[Pinball Paradise Official Website](#)



### [Odd Things Antique Shoppe](#)

A treasure hunter's delight. You can find a variety of antiques and collectables, including a unique collection of novelty cash registers.

417 S. Clinton Street

(309) 874-2364

[Odd Things Website](#)

## MAJOR EVENTS



### [Get Your 6.6 on Route 66!](#)

Late August

At 8 am Saturday, August 25, 2018, CORE of McLean, a nonprofit 501(c)(3) organization, is holding the 4th annual 6.6k (4.1-mile) run/walk on Route 66 from Funks Grove to McLean to benefit the community of McLean, IL. All proceeds will go to local projects. Favorites such as the pre-race shot of pure maple sirup and commemorative shot glasses, awesome t-shirts, and post-race food, drinks, and entertainment on the square will be back.

5257 Historic U.S. 66

630-202-8177

[Get You 6.6 on Route 66 Official Website](#)

## AMENITIES



### **Village of McLean**

121 S. Hamilton, P.O. Box 84

McLean, IL 61754

(309) 874-2102

[Village of McLean Official Website](#)

### **Accommodations:**



### **[Hotel Arcadia](#)**

Located in a historic downtown building, this private apartment is anything but old-fashioned. The two-bedroom accommodation has room for a party of six; includes a big screen TV, pinball machine and four arcade games. It is the only lodging space in the building, so laughter and fun won't bother the neighbors. The Hotel Arcadia is located next door to Arcadia: America's Playable Arcade Museum and the newly opened Pinball Paradise only a half block away. This unique lodging experience is also only a few blocks away from the iconic Dixie Truck Stop, three fast food options and the 1853 railroad depot.

107 South Hamilton Street

(309) 287-1725

[Hotel Arcadia Official Website](#)



**[Super 8 Motel](#)**

503 E. South Street

(309) 874-2366

[Super 8 McLean Official Website](#)

**[McLean Restaurants](#)**

[CLICK HERE McLean Google Map](#)



**Illinois Route 66 Scenic Byway**

700 East Adams

Springfield, IL 62701

(217) 525-9308

[info@illinoisroute66.org](mailto:info@illinoisroute66.org)

[www.illinoisroute66.org](http://www.illinoisroute66.org)